

The floor plan shows a rectangular building layout with the following dimensions and features:

- Overall Dimensions:**
 - Width: 8.10 (divided into 0.30, 3.75, 0.20, 3.40, 0.17, 3.50, 0.23, 3.90)
 - Depth: 5.00 (divided into 1.05, 1.80, 1.05, 0.17, 0.95)
- Internal Features:**
 - CUARTO DE BOMBAS:** Located in the lower-left section, containing a pump symbol labeled "N+0.15".
 - Boca de visita:** A square access point located in the upper-middle section.
 - CISTERNA:** A large rectangular tank area on the right side, outlined with a dashed border.
- Grid Lines:**
 - Horizontal grid lines are labeled 1 and 2 at the top.
 - Vertical grid lines are labeled A and B on the left.

Architectural section drawing showing a terrace (TERRAZA) and a cistern (CISTERNA). The drawing includes dimensions for heights and widths, and level markers.

Dimensions:

- Overall width: 3.90
- Width of terrace slab: 3.60
- Height of terrace slab: 0.40
- Height of terrace wall: 0.30
- Height of terrace wall (from ground level): 1.15
- Height of terrace wall (from ground level): 1.95
- Height of terrace wall (from ground level): 0.15
- Height of terrace wall (from ground level): 4.40
- Width of cistern: 0.25

Levels:

- N+4.15 (Terrace level)
- N+0.15 (Ground level)
- N±0.00 (Ground level)
- 3.15 (Cistern level)

TERRAZA

CISTERNA

N+4.15

N+4.

N+0.15

N±0.00

FACHADA POSTERIOR

ESCALA 1:50

Architectural drawing of the left facade (FACHADA LAT. IZQUIERDA) of a building. The drawing shows a large rectangular wall with two small square windows in the center. The drawing is labeled 'FACHADA LAT. IZQUIERDA' at the bottom. The drawing includes elevation markers: 'N+4.15' at the top right, 'N+0.15' at the bottom right, and 'N±0.00' at the bottom right. The drawing is scaled 1:50.



Ministerio
de **Transporte**
y **Obras Públicas**



ING. JULIO CESAR ZAMBRANO ZAMBRANO
DIRECTOR DE TRANSPORTE Y OBRAS PUBLICAS DISTRITAL DE MANABI

ARQ. JUAN PABLO VILLAFUERTE
DIRECTOR NACIONAL DE INFRAESTRUCTURA FÍSICA

ESQUEMA REFERENCIAL DEL PROYECTO:

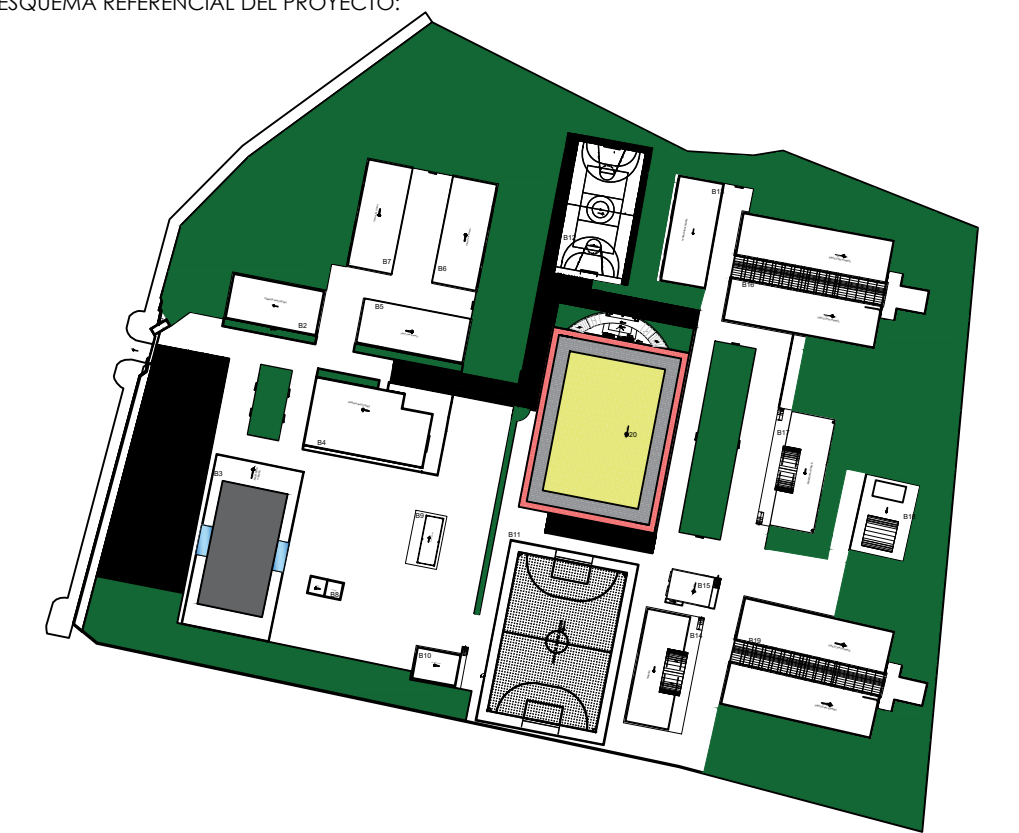

PROYECTO:	
-----------	--

"UNIDAD EDUCATIVA ESTANDARIZADA DEL MILENIO "
CAMPOZANO

UBICACIÓN:

MANABÍ
PROVINCIA

PAJAN
CANTÓN

CAMPUZANO
PARROQUIA

TIPOLOGÍA:

MAYOR

CONTIENE:

CUARTO DE BOMBAS Y CISTERNA BLOQUE A
PLANTAS, FACHADAS Y CORTES

ESCALA:

INDICADAS

FECHA:

NOVIEMBRE 2022

LÁMINA N.º

AR-12

DIBUJADO POR:

ING. KENIN MERCHAN

ELABORADO POR:	
----------------	--

ARQ. DIEGO AVILES

SELLOS MUNICIPALES: